

Page/



Homewood Early Learning Center

Homewood Early Learning Center Design Advisory Committee

Meeting 1: Vision for a New Facility

January 19, 2024





Agenda

1. Introductions
2. Design Process and Schedule
3. Where We Are
4. Visioning
5. Inspiration Images
6. Next Steps

Design Process and Schedule

Schedule | Design & Construction Phases

- 1 Programming & Concept Design**
 - Determine Capacity, Program, Size of Building, Site
- 2 Schematic Design**
 - Preliminary Exterior Design
 - Interior Space Adjacencies
- 3 Design Development**
 - Room-by-room design
 - Interior Finishes
- 4 Construction Documents**
 - Details
 - Permit and Construction
- 5 Construction Phase → Licensing → Opening**

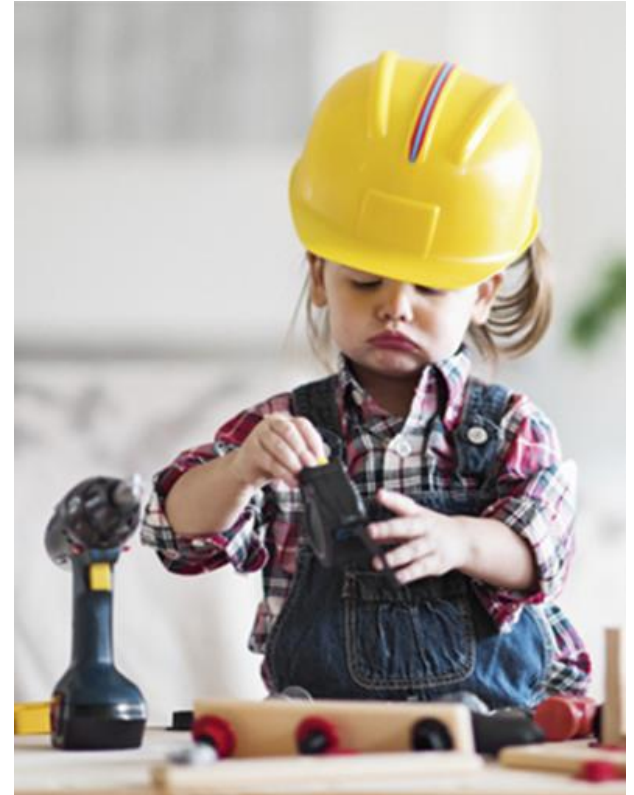

Schedule

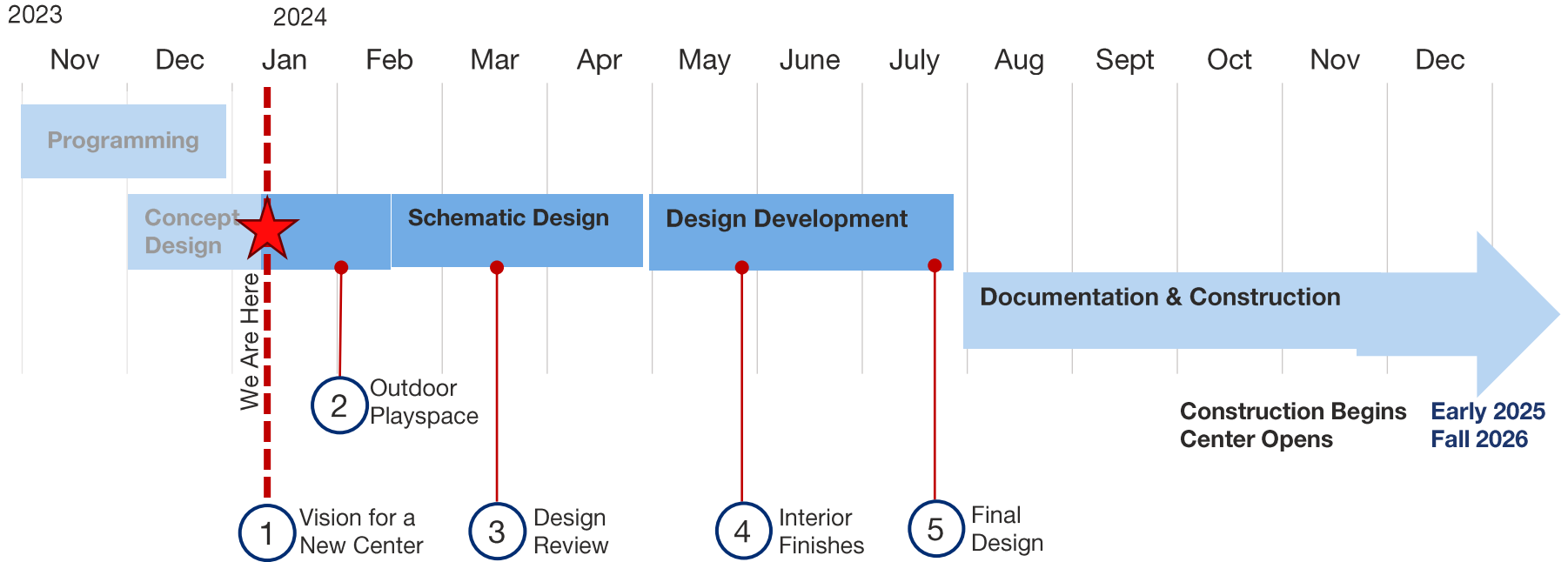

Where We Are

Program Capacity

	Current		New	
	Capacity	Classrooms	Capacity	Classrooms
Infants	18	3	30	5
Toddlers	18	2	36	4
2-year-olds	24	2	48	4
Preschool	32	2	48	3
Totals	92	9	162	16



W. University Parkway

W 39th St

W 39th St

San Martin Dr

San Martin Dr

San Martin Dr

Hopkins House
Apartments

DeCamps Orthodontics

Cypriana
Mediterranean • SS

Berkeley Dundee
Condominium...

Canterbury Hall
Apartments

Carolina Apartments

University West

Camp-us@Lincoln C

First Church of
Christ, Scientist

Salon Tesjo

One World Cafe

Imagine Center for
Integrative Learning...

Residences At
the Colonnade

Homewood Field Lot

Inn at Th
Baltimore

North Visitor Lot

North Gate

Homewood Field

8

Site Analysis | University Parkway Parcel

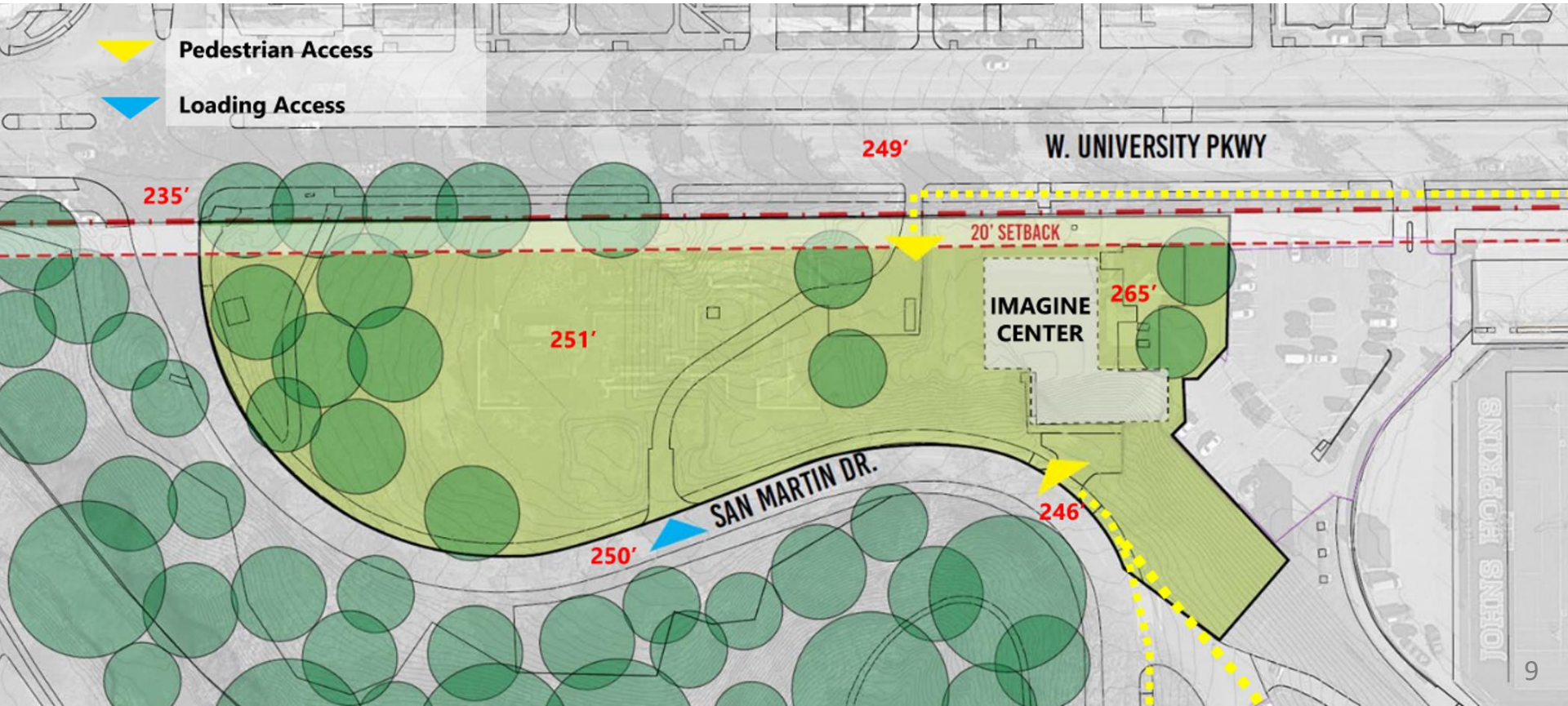

Two-Story Building

Drop-off/ Pick-up

- Infants and Toddlers on same level as entry
- 2s and older use stairs/elevator to get to classrooms and for emergency egress

Playground

- Infants/Toddlers have direct access and are same level as playground
- 2s and older use stairs or elevator to access playground

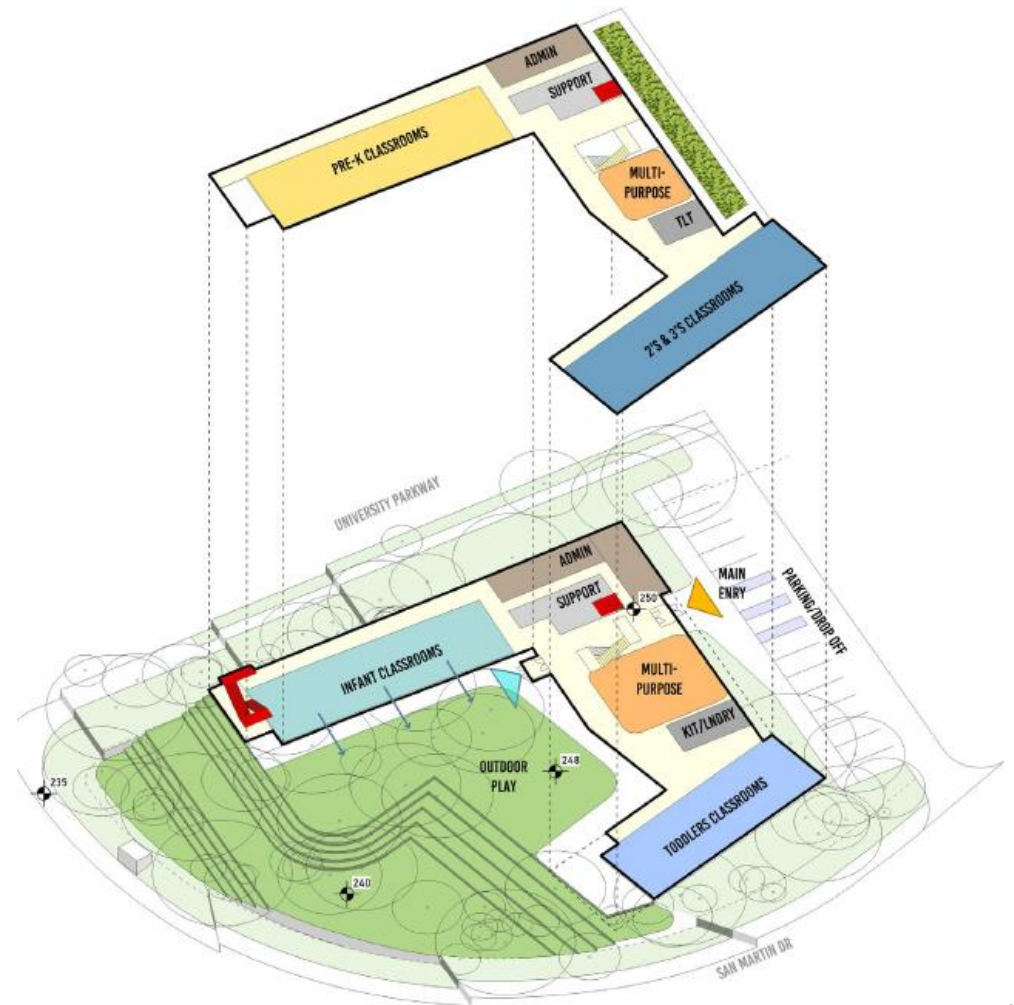

Program Features

- Newly-built Permanent Center on Homewood Campus
- Large Windows → Natural Light, Playground Views
- High Ceilings
- Generous Classroom Space
- Enhanced and enlarged Indoor Play Area (also serves as Multi-purpose Room)



Program Features

- Increased Storage
- Increased Adult Restrooms
- Improved Food Prep
- Lactation Room
- Conference Space
- Expanded Staff Support Space



Site / Outdoor Features

- Enhanced playground with natural elements
- Fencing and landscaping will provide buffer from street
- Playground will have seating for adults
- Child restroom accessible from Playground
- Outdoor Storage



Inspiration Images













INQUIRY





Next Steps

Parent Advisory Committee Meetings

- 1 Vision for a New Center**
January 19
- 2 Outdoor Playspace Design Charette**
February 2
- 3 Design Review**
Week of March 11
- 4 Interior Finishes Presentation**
Week of May 20
- 5 Final Design**
July / TBD

Participants:

Shannon Bohrer	University Administration, Sr. Staff
Casey Lurtz	KSAS, Faculty
Mathias Unberath	WSE, Faculty
Gregory Ridout	Homewood Student Affairs, Sr. Staff
Nick Papageorge	KSAS, Faculty
Zunlin Yang	SOM Fellow
Ricardo Sanchez	KSAS, Staff
Mary Colleen Buettner	Provost Office
Annie Reyes	DBCC, ELC Center Director
Hilary Roberts-King	DBCC, Executive Director
Erica Brown	DBCC, ELC teacher
Margo Sipes	Child care Consultant

JHU HR Benefits Team
JHU Facilities and Real Estate Team
External Consultants